

Ringön is reimagined as an elevated urban landscape that evolves with the rising waters. The project proposes a pedestrian path and park system as a starting point for the gradual transformation of the site. Through the reuse of existing structures as a foundation for the new landscape, current ground-level functions are preserved while offering a clean slate for a sustainable future above ground. This new urban landscape will move beyond human-centered planning, fostering innovative solutions and coexistence, which aligns with Ringön's spirit of creativity and inclusivity.

FLUID FLOWS

AN ELEVATED LANDSCAPE



YEAR 2100

A PROCESS WITH TIME...

ACCESS POINTS



FLOWS & MOBILITY

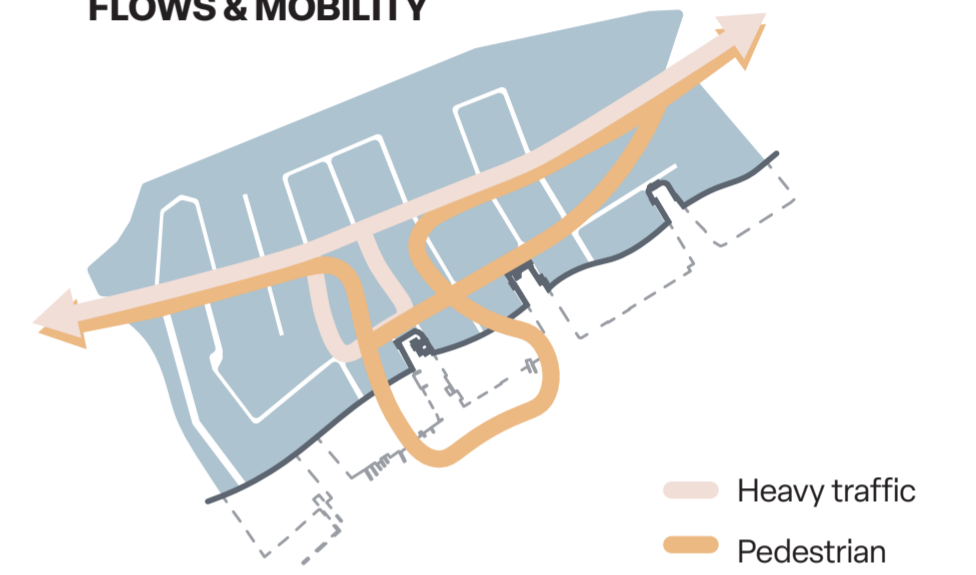

GREENERY



WATER MANAGEMENT

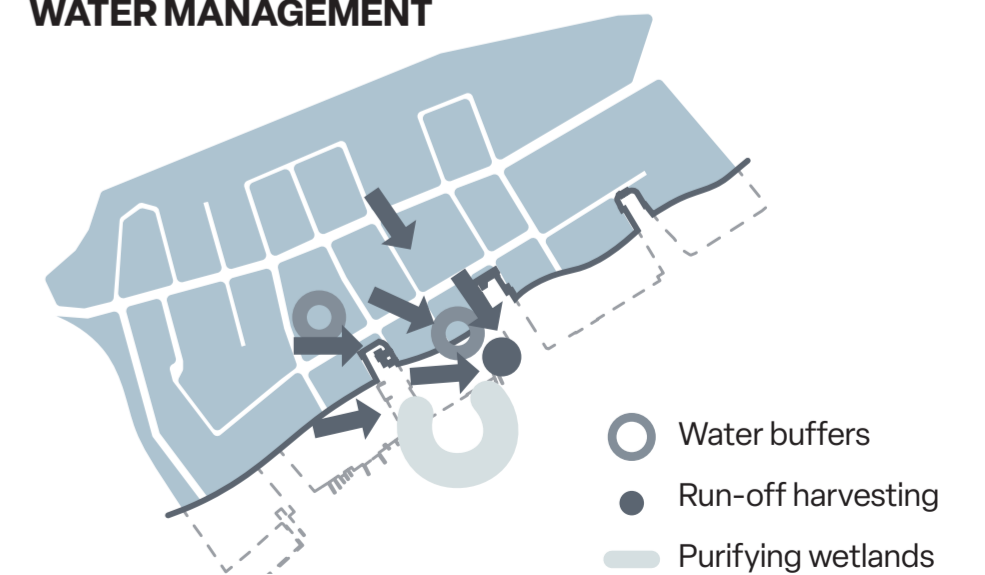

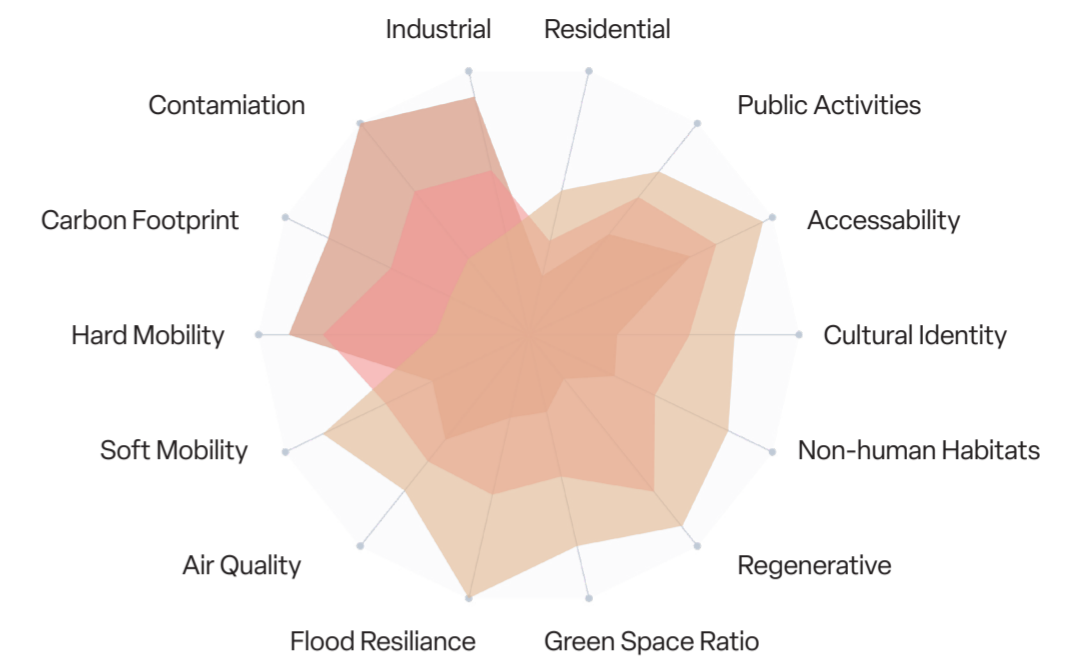
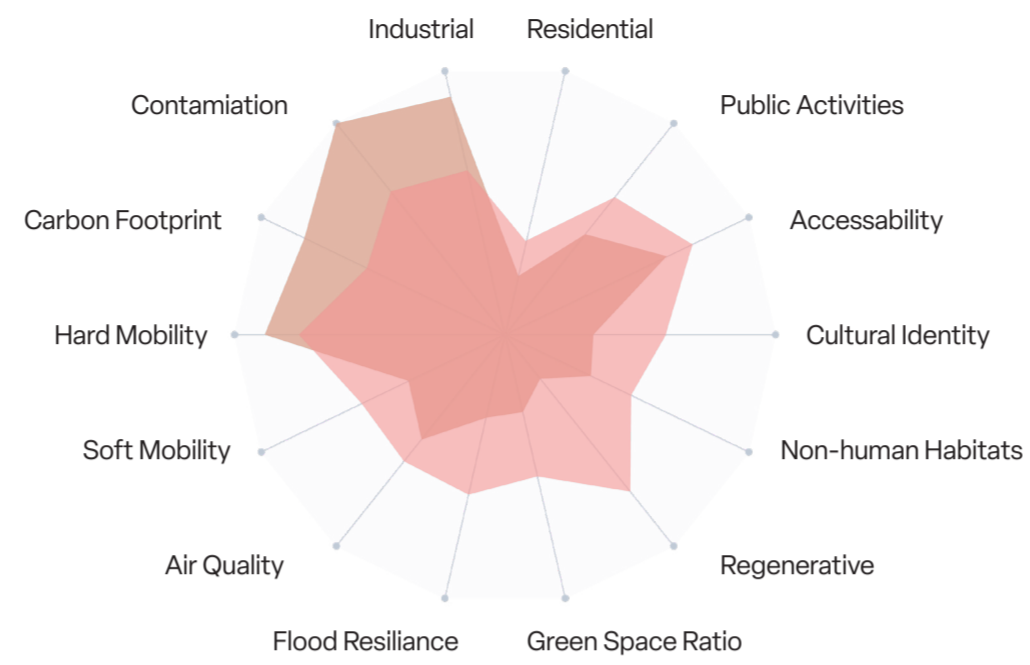
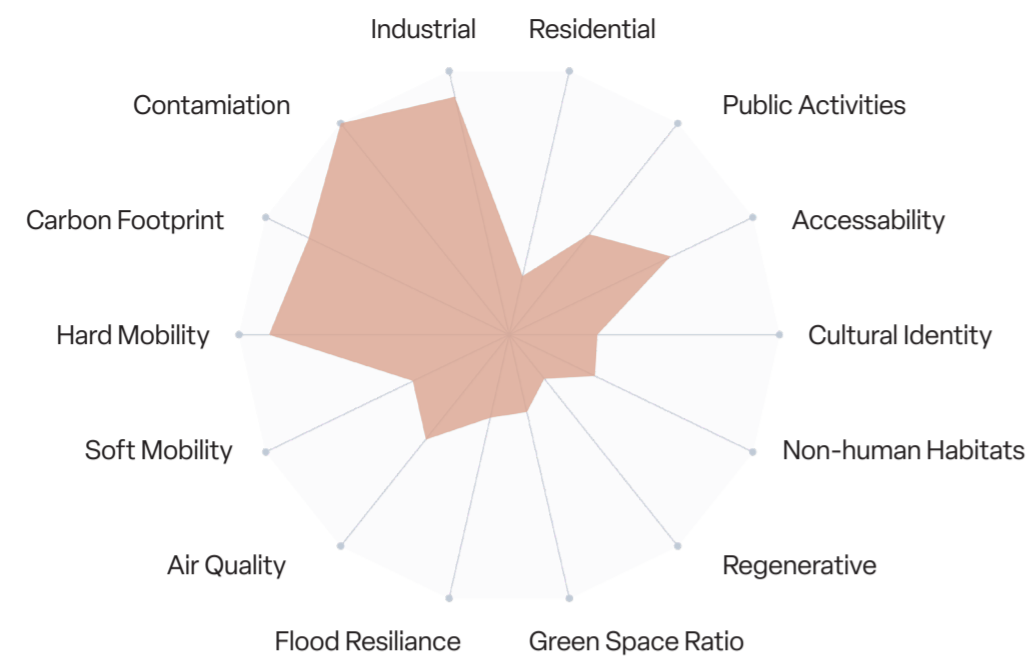

RINGÖN 2050

The elevated path is constructed to separate industrial traffic from public movement. The waterfront area adjusts to rising water levels by incorporating floating structures and transforming the former shipyard into a container hub.

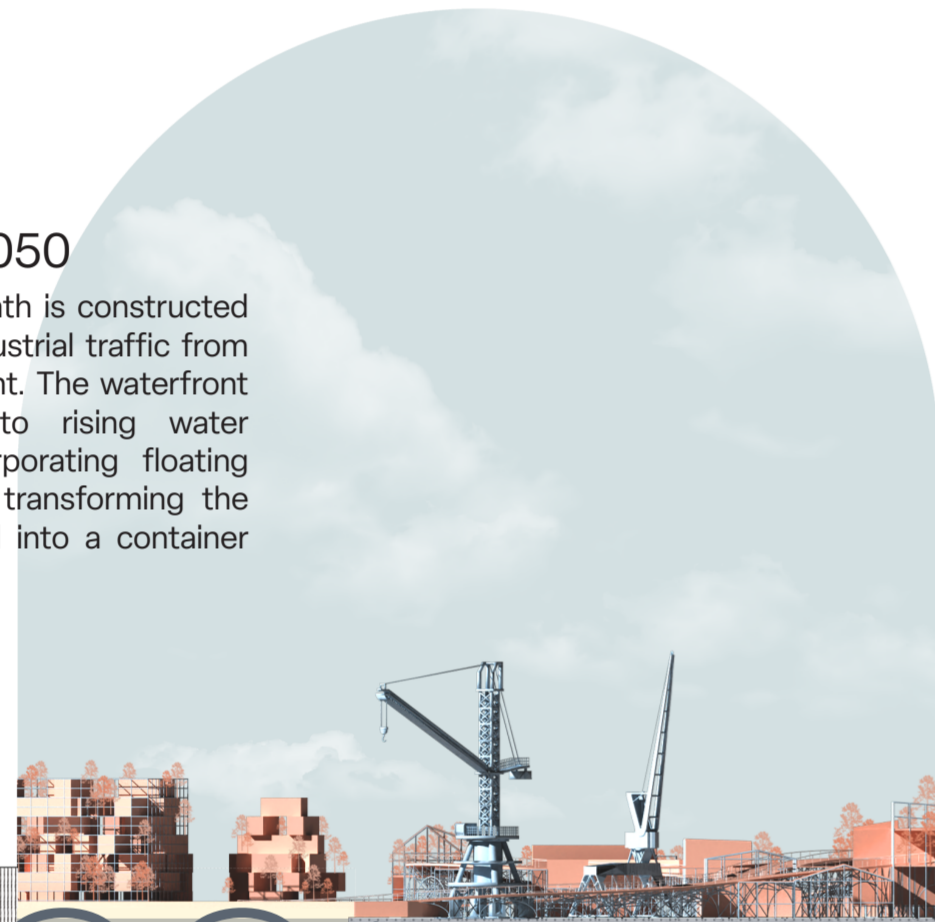

RINGÖN 2100

As the river levels rise, more of the built environment will need to be dismantled, providing additional materials for constructing the elevated landscape, as a new urban dimension begins to take shape.



RINGÖN 2500

Water now covers almost the entire island, returning the site to its original state as a wetland. The elevated landscape provides a blank canvas for a complete reimagining of society, fostering a balanced urban space with symbiotic networks.



A-A

Water-Greenery-Land

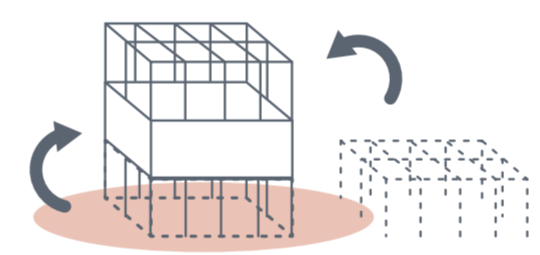
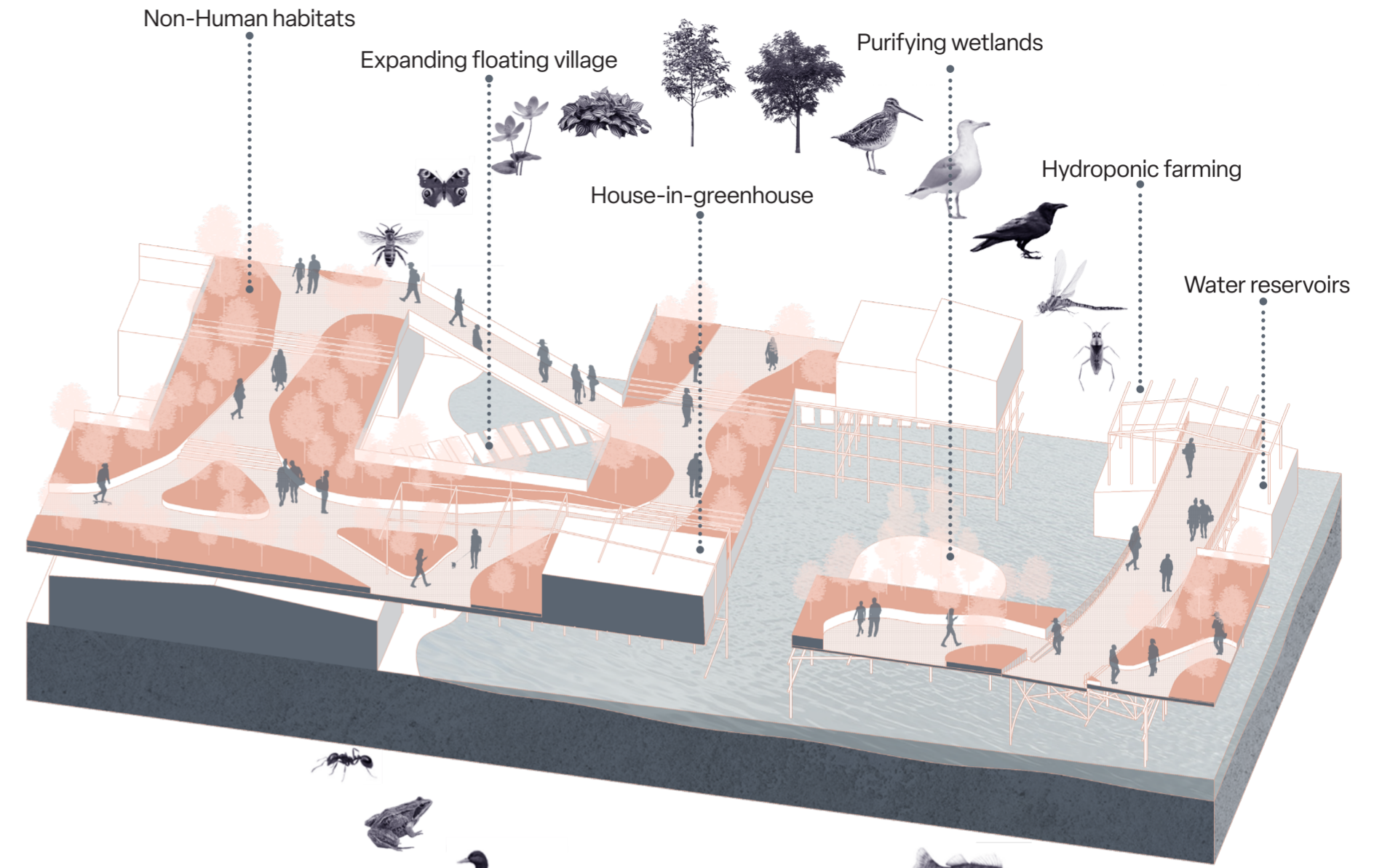
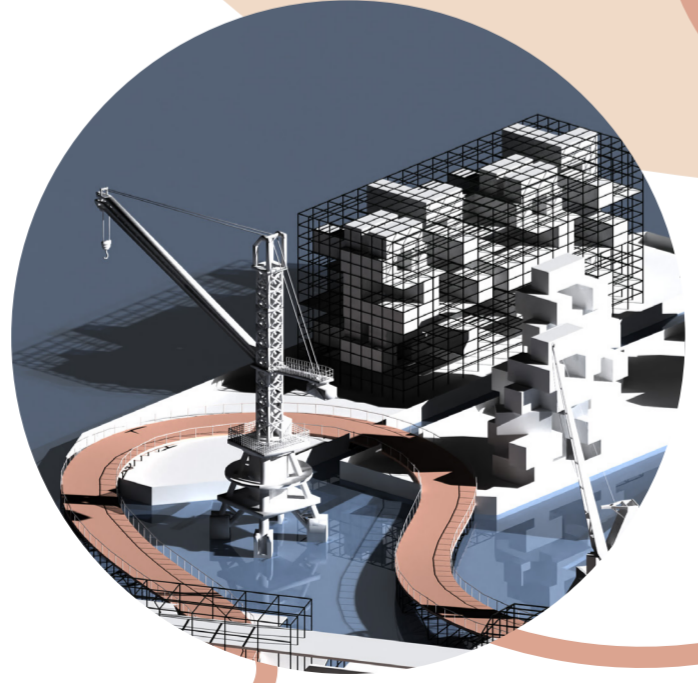
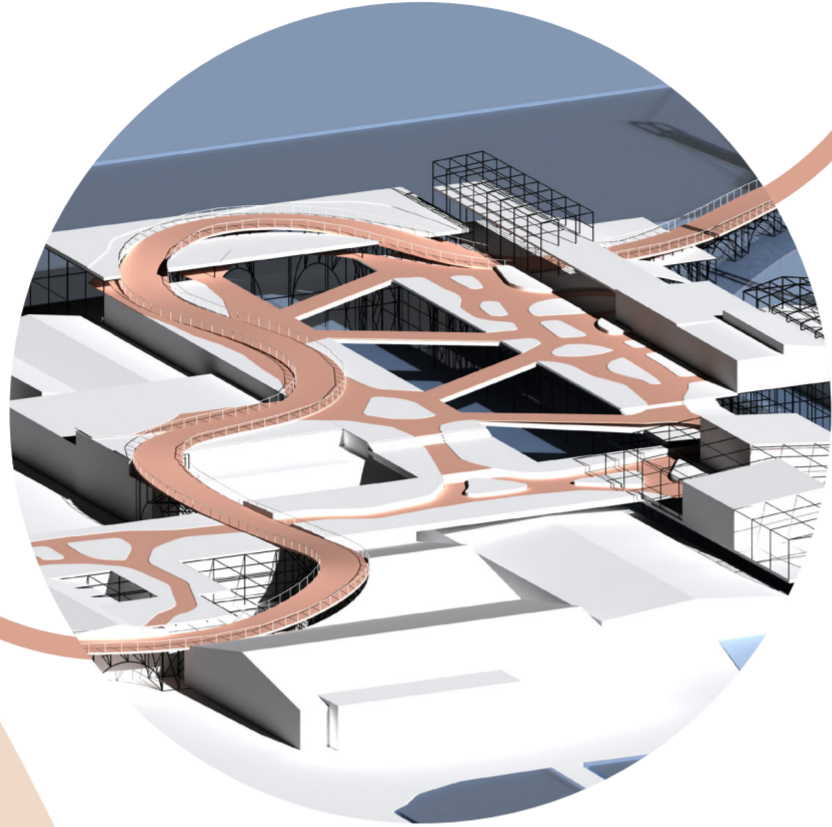
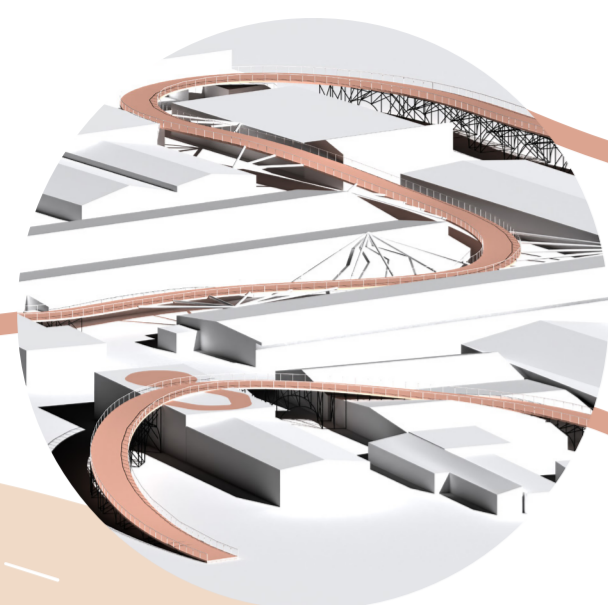

Reusing flooded structures for vertical living



High buildings kept as weather protection

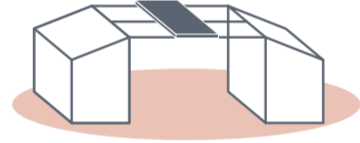

Preserving ground-level mobility



Allowing for rewilding of flooded land

